

Auditor's Office

Tuscarawas County

LARRY LINDBERG, Auditor
125 E. High Avenue
New Philadelphia, Ohio 44663

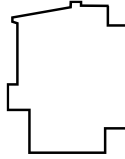

Telephone
(330) 365-3220
Fax: (330) 365-3397

Vendor Contact Information Update Form

Location Information Verification

For Location #1 (refer to the letter):

This address is correct.

This address is incorrect, new address is:

Please mark this address as inactive. It is no longer valid.

This address is our main address.

This address is our Remit Address (we can send our Payments to you).

This address is for items other than Remit (please add a note below)

Other (please specify)

Contact Information-Location #1

Primary Contact Name:

Primary Contact Email:

Primary Contact Phone: